

S Type Load Cell



(Picture just for reference)

Product features:

The steel square S type tension and compression sensor can withstand both tension and compression external forces, with good output symmetry, compact structure, easy installation, and complete specifications. The TQ-A1 square S type tension and compression load cell is suitable for the manufacture of electromechanical scales, hook scales, hopper scales and various special scales, process scales, etc.

Range :

10N(1kg)、20N(2kg)、30N(3kg)、50N(5kg)、100N(10kg)、200N(20kg)、300N(30kg)、500N(50kg)、1kN(100kg)、2 kN(200kg)、3 kN(300kg)、5 kN(500kg)、10 kN(1t)、20 kN(2t)、30 kN(3t)、50 kN(5t)、100 kN(10t)、150 kN(15t)、200 kN(20t)

Specifications :

No.	Specification	
1	Rated load	1kg、2kg、3kg
2	Accuracy	0.05%F.S

3	Sensitivity	1.0mV/V
4	Zero output	≤0.1%F.S
5	Input resistance	380±20Ω
6	Output impedance	351±3Ω
7	Insulation resistance	≥5000MΩ
8	Compensation temperature range	-10~40°C
9	Applicable temperature range	-30~70°C
10	Safety overload	150%F.S
11	Ultimate load	300%F.S
12	Material	High quality aluminum alloy
13	Excitation voltage	10V(DC)
14	Sealing grade	IP67
15	Cable	2m
16	Wiring	Red...E+ (input positive) Black...E- (input negative) Green...S+ (output positive) White...S- (output negative)

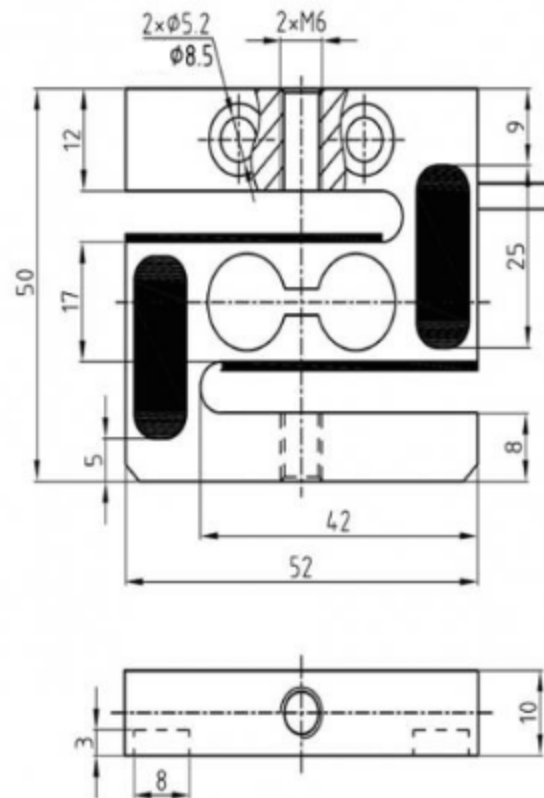

No.	Specification	
1	Rated load	5-20000kg
2	Accuracy	0.02%F.S
3	Sensitivity	2.0mV/V±0.2%
4	Input resistance	385±15Ω

5	Output impedance	350±3Ω
6	Insulation resistance	≥5000MΩ
7	Compensation temperature range	-10~40°C
8	Safety overload	150%F.S
9	Material	Alloy steel
10	Excitation voltage	10V(DC/AC)
11	Sealing grade	IP67
12	Cable	3m
13	Wiring	Red...E+ (input positive) Black...E- (input negative) Green...S+ (output positive) White...S- (output negative)

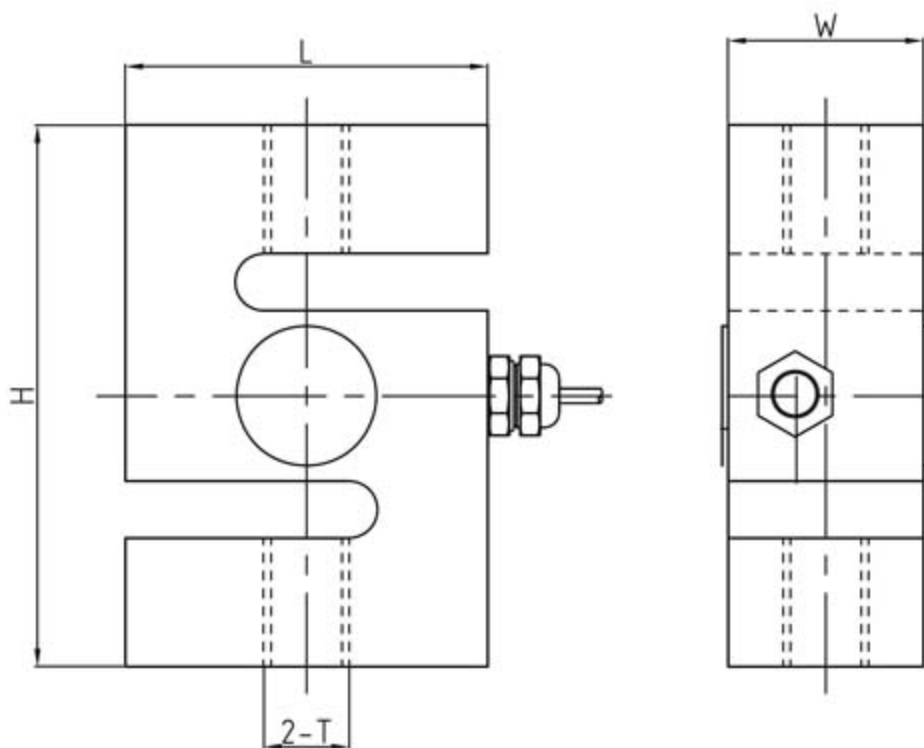

Model	Measuring range (kN)	Measuring range (kg)	L	H	W	T
TQ-A1	0.05-0.5	5-50	51	64	13	M8×1.25
	1-5	100-500	51	76	19.1	M12×1.75
	10-20	1000-2000	54	76	25.4	M12×1.75
	25-50	2500-5000	76	108	25.4	M18×1.5

	75	7500	100	140	32	M24×2
	100	10000	126	178	50	M30×2
	150-200	15000-20000	140	188	60	M39×2
TQ-A1T	S-A1T-0.5	50	51	76	19.1	M12×1.75
	S-A1T-20	2000	76	108	25.4	M20×2.5
	S-A1T-30	3000	70	86	45	M20×2.5
	S-A1T-50	5000	76.2	108	40	M20×2.5



Authentication Certificate of Quality Management System

Registration No.19922Q01072R0S

This is to certify that

Jinan Kason Testing Equipment Co., Ltd.

Unified Social Credit Code: 9137010458994939X0

Registered/Production Address: No. 4715, Jingshi West Road,
Huaiyin District, Jinan City, Shandong Province

Office Address: Room 2-1108, Harmony Square, Huaiyin District, Jinan City

Is in conformity with :

GB/T 19001-2016/ISO 9001:2015

The certificate is valid for the following scope :

Assembly and sales of testing machines

This certificate should be used effectively with the legal requirements of the administrative license, qualification license, compulsory certification, which the certification scope involved.

In the case that the organization regularly receives surveillance assessments, the certificate shall be valid when used together with the Quick Response Code.

Date of Issue: 2022-07-19

Date of Expiry: 2025-07-18

Date of Initial Certification: 2022-07-19

General Manager



中国认可
国际互认
管理体系
MANAGEMENT SYSTEM
CNAS C182-M

China Standard Huaxin (Beijing)
Certification Center Co.,Ltd.



Address of Certification Authority: 5 Floor, YuQuan Building, No.3 Shijingshan Road, Shijingshan District, Beijing Tel: 010-88255986 P.C.: 100049

Note: The detailed information is available on the Certification and Accreditation Administration of the People's Republic of China official website (www.cnca.gov.cn) the authority's website(www.cshcc.cn) and the Quick Response Code on the left.



MACHINERY DIRECTIVE ATTESTATION OF CONFORMITY

Technical file of the company mentioned below has been inspected and audit has been completed successfully.

2006/42/EC Machinery Directive Annex VIII has been taken as references for these processes.

Company Name	: Jinan Kason Testing Equipment Co., Ltd.
Company Address	: No.4715, Jingshi West Road, Huaiyin District, Jinan, Shandong, China
Related Directives and Annex	: 2006/42/EC Machinery Directive/Annex VIII
Related Standards	: EN ISO 12100:2010; EN 60204-1:2018
Product Name	: Testing Machine
Report No and Date	: TCF-JKTE230605-MD
Product Brand/Model/Type	: WDS-1, WDS-2, WDS-3, WDS-5, WDS-10, WDS-20, WDS-30, WDS-50, WDS-100, WDS-200, WDS-300, WDW-1E, WDW-2E, WDW-3E, WDW-5E, WDW-10E, WDW-20E, WDW-30E, WDW-50E, WDW-100E, WDW-200E, WDW-300E, WDW-500E, WDW-600E, WDW-1000E, ETM103, ETM203, ETM303, ETM503, ETM104, ETM204, ETM304, ETM504, ETM105, WE-300D, WE-600D, WE-1000D, WE-2000D, HUT305S, HUT605S, HUT105S, HUT126S, WEW-300D, WEW-600D, WEW-1000D, WEW-1200D, WEW-2000D, WEW-3000D, HUT305E, HUT605E, HUT105E, HUT126E, HUT-A306E, HUT-A206E, WAW-300D, WAW-600D, WAW-1000D, WAW-1200E, WAW-2000E, WAW-3000, WAW-2000A, WAW-3000A, WAW-4000A, HUT-A206W, HUT-A306W, HUT-A406W, HUT305W, HUT605W, HUT105W, HUT126W, WAL-LAW, HUT-L, JB-300, JB-300B, JB-500B, JBS-300, JBS-500, JBW-300, JBW-500, JBDW-300, JBDW-500, CST-50, VU-2Y, VU-1S, DWC-40, DWC-60, DWC-80, DWC-100, DWC-196, YES-1000, YES-2000, YES-3000, YAW-1000, YAW-300, YAW-2000, YAW-3000, YAW-5000, NDS-200, NDS-500, NDS-1000, NDS-2000, NDW-200, NDW-500, NDW-1000, NDW-2000, NDW-3000, NDW-5000, NDW-10000, EZ-1, EZ-3, EZ-10, JWJ-10, TIS, TLW, HWS, PLS-20, PLS-50, PLS-100, PLS-300, PLS-500, PLS-1000, KASON-1, RDJ-10, RDJ-20, RDJ-50, RDJ-100, DWTT-20000, DWTT-30000, DWTT-40000, DWTT-50000, DWTT-80000, DWTT-100000, PIF-302, PIF-302M, PIF-502, PIF-502M, PIF-302T, PIF-502T, PIF-302W, PIF-302TW, PIF-502W, PIF-502TW, PIF302CW, PIF452CW, PIF602CW, PIF752CW, PIF302CT, PIF452CT, PIF602CT, PIF752CT, PIFD302W, PIFD502W, PIFD302T, PIFD502T, PIFD302CW, PIFD452CW, PIFD502CW, PIFD752CW, PIFD752CT, PIFD302G, HCT106, HCT206, HCT306, KSCM, HYJ, HEZ-3, HEZ-5, HEZ-10, HEZ-20, KSBT-10, KASON 370.02, KASON 370.05, KASON 370.10, KASON 370.25, KASON 370.50, MMW, GBW-60B, GBS-60B, HUT, ETM, XNR, GW-40, GW-50, MRS, MMU, MRH, GBW, GW, LSW, HBT, GLY, GCJ-1000, GWQ-1000, GZQ-1000, GQR-1000, GJR-300, GSS-1000, GMS-100, GTW-500, GQC-5, GGG-100, HR-150A, HRD-150, HRS-150, XHR, HB, HVS, HV, HBRV, W-20, HBA-1, LHT, Q-2A, MP-2, XQ-2B, XD-30M, 4XCE, 4XB, JSZ, MOPAO, MPT, P, MP, BG, LBG-32, MPJ-35, Q-Z, Q-100B, SQ, Q-3A, QG-4, LSQ, LDQ, GTQ-5000A, GTQ-5000B, DTQ, ZXQ, 4XC, HST, KASON, KS, KSCUT, HTR, HTPR, HTB, HSTR-45S, HTV, HTMV, HTBRV, METRPRESS, MPJ

Certificate Number	: M.2023.206.C86313
Initial Assessment Date	: 07.06.2023
Registration Date	: 08.06.2023
Reissue Date/No	: -
Expiry Date	: 07.06.2028

UDEM International Certification
Auditing Training Centre Industry
and Trade Inc. Co.

The validity of the certificate can be checked through www.udem.com.tr. Upon completion of EC declaration of conformity it is used solely at the manufacturer's responsibility. This certificate remains the property of UDEM International Certification Auditing Training Centre Industry and Trade Inc. Co. to whom it must be returned upon request. The above named firm must keep a copy of this certificate for 15 years from the registration of certificate. This certificate only covers the product(s) stated above and UDEM must be noticed in case of any changes on the product(s)
Address: Muthukent Mahallesi 2073 Sokak (Eski 93 Sokak) No:10 Çankaya - Ankara - TURKEY
Phone: +90 0312 443 03 90 **Fax:** +90 0312 443 03 76
E-mail: info@udem.com.tr www.udem.com.tr



FOCUS IN MATERIAL TEST

KASONTTEST®

JINAN KASON TESTING
EQUIPMENT Co., LTD.

Duandian Industrial Park , Jingshi Road, Jinan City, China.

P: +86 159 10081986

E: admin@jnkason.com | W: www.syjlab.com

